



The Sqair

Simple, no-nonsense clean air

Story behind The Sqair

The world doesn't need another purifier company that overcharges you for clean air. The Sqair is a purifier that's been stripped down to its active ingredients: a fan and a filter. That's all you need to breathe clean air.



*Minimalist
design*



*Energy
efficient*



*Extremely
quiet*

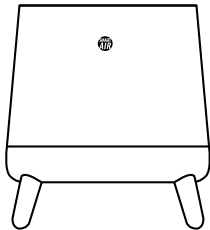

No hype, no mark-up, just clean air.

About Smart Air

Smart Air is a social enterprise and certified B-corp dedicated to distributing cost-effective air purifiers and providing open-source data and science to combat the harms of air pollution. Learn more:

Certified



Corporation

bcorporation.net



The Sqair: bang for your buck

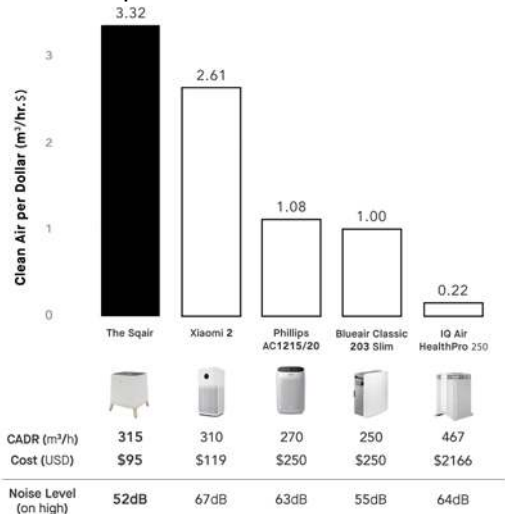

We designed The Sqair to do one thing: clean air. And it does that one thing really well. The Sqair gives you more clean air for your money than any other purifier in the world, and it's quieter too.

What's inside The Sqair?

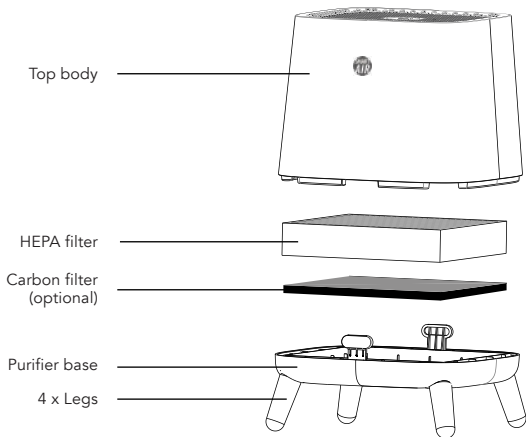

Not everyone needs a carbon filter.
Scan to find out if you do:



Setting up The Sqair

Before you start breathing clean air, you'll need to get your Sqair ready for action. Here's how:

Step 1: Attach the legs

Screw the four wooden legs, in a clockwise direction, into the four screws in the base of the purifier.

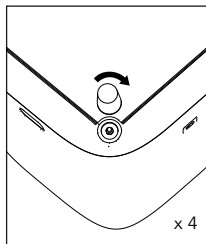

Step 2: Set up your filters

1. Open your purifier

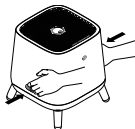

Be careful not to trap your fingers!

2. Remove the filters from their bags



3. Put the filters back, making sure the arrows are in the right direction



Note: if you're using a carbon filter, make sure you insert it in the right order:
Carbon filter (bottom) → HEPA filter (top)

Turning on The Sqair

After removing the filters from their packaging, you're ready to power up.

1. Plug in your power cable
2. Rotate the dial on top to turn on your Sqair

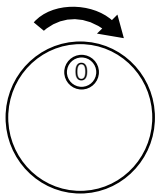

The Sqair has 3 speeds. Here's what they do:

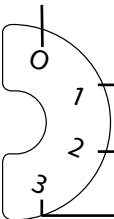
Off	Speed	Particulate CADR	Noise Level	Noise Level	Room size cleaned in 20 minutes
	1	65m ³ /h (40cfm)	23dB	6W	9m ² (97ft ²)
	2	180m ³ /h (110cfm)	43dB	19W	25m ² (269ft ²)
	3	315m ³ /h (190cfm)	52dB	38W	43m ² (470ft ²)

Note: if you're using a carbon filter along with a HEPA in your Sqair, performance will vary. For full info, check out smartairfilters.com/sqair

How to replace your filters

You should replace your filters regularly to make sure your Sqair is working as efficiently as possible. For an average usage of 8 hours per day, we recommend changing your HEPA filter every 4 months and your carbon filter every 3 months.

1. Remove the power cable



2. Open up The Sqair

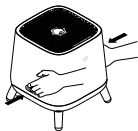

3. Remove and replace the filters, taking note of the direction arrow on your filters

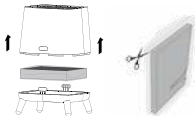

4. Re-assemble and plug your Sqair back in



We hate giving "standard" numbers on when to change your filter, because people's use and environment varies. Scan here to get an individualized calculation for how long your filters will last.



What next? Filters, Masks & Monitors

You've made the smart move and kitted yourself out with simple, no-nonsense clean air. But don't stop there!



Need replacement filters? Scan this QR code to order through our online store:



Want to know how clean your indoor air really is, or want a smarter way to know when to replace your filters? Check out our report on which air quality monitors can help:



We spend 80% of our time indoors, so you're protected most of the time with The Sqair. But what about when you're outside? Check our data on which masks are effective:



Common problems

Issue/question	Possible cause	Possible solution
My Sqair doesn't turn on	Power cable is not connected to The Sqair or a power supply	Ensure the power cable is securely connected to The Sqair and the power supply
	The Sqair's speed dial is in the '0' position	Rotate the speed dial to either 1, 2, or 3
The airflow seems to be a lot lower than before/what I was expecting	The filters haven't been removed from their plastic wrapping	Open up your Sqair and make sure you've removed the filter from its plastic packaging
	The Sqair's inlet is blocked or obstructed	Make sure you have screwed on all four legs, and all sides of The Sqair are at least 15cm from nearby objects
	The speed dial is at a low setting	Turn the speed dial to a higher setting
	The filter needs replacing	Work out how long you've been using your filter, and replace it if necessary
I'm not getting the performance I expected	The room size exceeds one Sqair's recommended room size (40m ²)	Use the air purifier in a room with applicable area or add another Sqair
	Outdoor air pollution levels are extremely high	Smart Air data shows that all purifiers perform worse when outdoor air pollution levels are high. Learn more: 
	Doors and/or windows are open	Open doors and windows might mean outside air can seep into your room. Make sure your doors and windows are closed for best performance

FAQ

Question

Answer

Can I wash my HEPA filter?

We've run tests that show washing HEPA filters doesn't work. Check out this answer:



Where can I get replacement filters?

Head to smartaifilters.com/sqair/hepa for a full list, or scan the QR Code:



Head smartaifilters.com/data for more data and commonly asked questions.



Important Safety Instructions

Read this user manual carefully before you use your Sqair, and be sure to save it for future reference!

Danger

- Do not let water or any other liquid or flammable detergent enter The Sqair to avoid electric shock and/or a fire hazard.
- Do not clean The Sqair with water or any other liquid or a (flammable) detergent to avoid electric shock and/or a fire hazard.

Warning

- Ensure the voltage indicated on the back of the purifier corresponds to your mains voltage.
- If the supplied cable is damaged, you must have it replaced by distributor, or a service center authorized by distributor or similarly qualified persons in order to avoid a hazard.
- Do not use The Sqair if the plug, the mains cable or the machine itself is damaged.
- Children should be supervised to ensure that they do not play with the purifier.
- Do not block the air inlet and outlet, e.g. by placing items on the air outlet or underneath the purifier at the inlet.

Caution

- This purifier is not a substitute for proper ventilation, regular vacuum cleaning or use of an extractor hood or fan while cooking.
- If the wall socket used to power the purifier has poor connections, the plug may become hot. Make sure you plug the appliance into a properly connected wall socket.
- Always place and use the appliance on a dry, stable, level and horizontal surface.
- Leave at least 15cm free space behind and on all sides of the purifier and leave at least 40cm free space above the appliance.
- Do not place anything on top of the purifier and do not sit on the purifier (even if it looks comfy!).
- Do not place the purifier directly below an air conditioner to avoid condensation from dripping onto the appliance.
- Make sure all filters are properly installed before you switch on the appliance.
- Avoid knocking against the purifier (the air inlet and outlet in particular) with hard objects.
- Use both hands to pick up The Sqair when moving it or replacing the filters.
- Do not insert your fingers or objects into the air outlet, even when your Sqair is powered off.
- Do not use this purifier when you have used indoor smoke-type insect repellents or in places with oily residues, burning incense or chemical fumes.
- Do not use the purifier near gas appliances, heating devices or fireplaces.
- Always unplug the purifier after use and before you clean it or change the filters.
- Do not use the purifier in a room with major temperature changes, as this may cause condensation inside the appliance.
- The purifier is only intended for household use under normal operating conditions.
- Do not use the purifier in wet surroundings or in surroundings with high ambient temperatures, such as the bathroom, toilet or kitchen.
- The purifier does not remove carbon monoxide (CO). It cannot be used as a safety device in case of accidents with combustion processes and hazardous chemicals.